

ACC CD Player Skips

It's not unusual for a CD player to skip occasionally when driving over large pot holes, deteriorated railroad track crossings, parking lot speed bumps, etc. However, if the player skips under normal driving conditions, check the following before you assume the player or changer is at fault:

- Check the disc. The laser pickup won't track properly if there are large obstructions (i.e., finger prints, foreign material) between it and the data. Scratches in the disc material that follow the tracks can also cause problems. Hold the disc up to the light and check for pin holes or scratches on the label side of the disc – they can cause the player to skip, repeat an area, or not play at all.
- Make sure the shipping screws were removed. (Refer to the installation instructions for the screw locations.) If the screws are not removed, the player's suspension system can't dampen the bumps when the car is driven.
- Make sure the changer support springs are in the appropriate position for the mounting angle of the changer (vertical or horizontal).

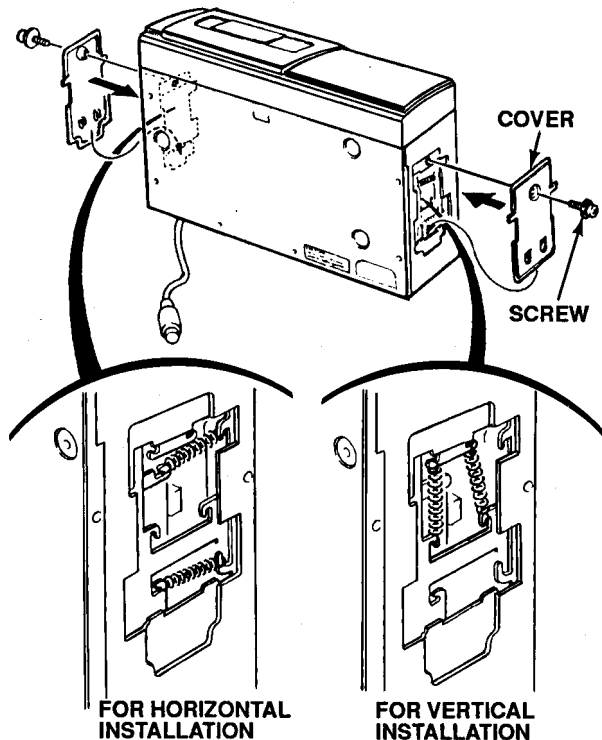

- Make sure the changer is mounted securely to its bracket and the bracket is mounted securely to the car.



Low Pedal After Legend Clutch R & R

A low clutch pedal immediately after a clutch replacement on an '86-90 Legend could mean the release fork set clip is sitting on top of the fork bolt ball, instead of under it. This moves the release fork too far away from the slave cylinder, hence the low pedal. Luckily, however, you can unbolt the slave cylinder and reposition the release fork and set clip without removing the trans.

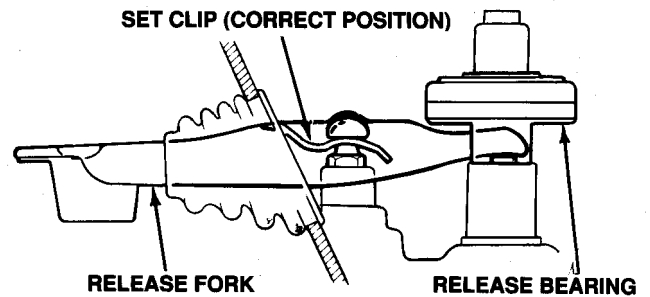

Twisted Belt Buckles

To correct a seat belt buckle that has turned itself 180 degrees about the belt, fold the belt over diagonally and slide the buckle over it. To check the orientation of the buckle, it should face inward when not in use.

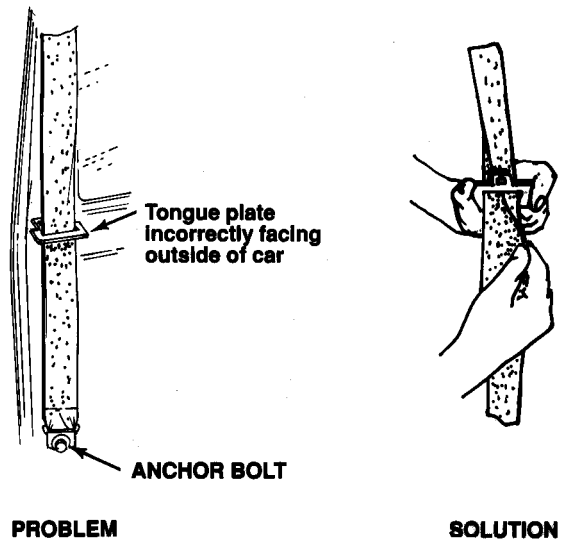

Legend M/T Torque

Part of the 1b-ft torque conversion for the '91 Legend Sedan M/T mainshaft nut is incorrect. Correct page 13-38 of your S/M to read 116 > 0 > 116 lb-ft, instead of 116 > 0 > 16 lb-ft.



Squeal When You Turn the Wheel

Got a '91 Legend that squeaks or squeals when you turn the steering wheel? If it sounds like the noise is coming from the lower steering column area, try a little penetrating lube on the steering joint grommets and the pinion dust cover.

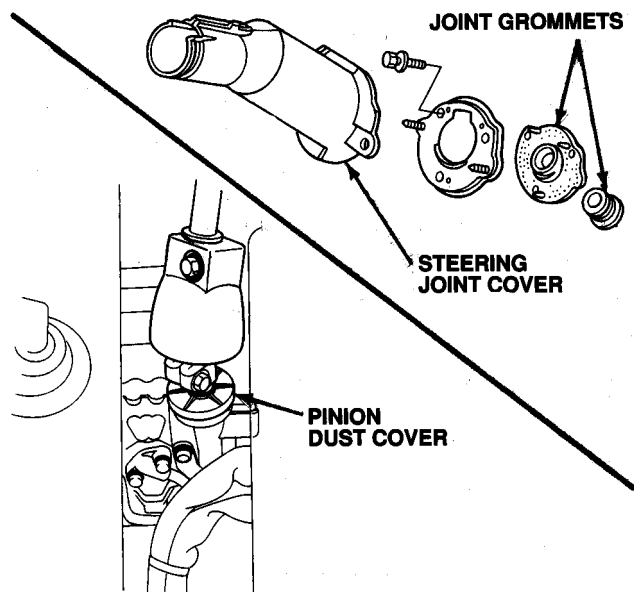

Replacement Leather

Damaged Legend leather upholstery can be repaired with replacement panels, rather than by replacing the entire seat cover or door panel. For Sedan panels, contact Eagle Ottawa Leather Company at 616-842-4000. For Coupe panels, contact Garden State Tanning at 215-944-7601. When you call, be prepared with the car's year, model, interior color, and the dimensions of the damaged panel.



Bad Connection at the Control Unit?

What's the best way to confirm a bad connection at a control unit connector? Remove the female terminal from the connector body, then see how snugly it fits over the control unit's male terminal. If the female terminal fits loosely, you can probably "adjust" it to restore a good connection. (Or, if worse comes to worst, most control unit connector terminals are replaceable.)



Legend Rear Suspension Noise

Dry trailing arm bushings may cause a clunking or creaking noise on '89-90 Legends. If the noise sounds like it's coming from under the rear seat cushion (where the trailing arms attach to the body), remove the trailing arm mounting bolts and lubricate the trailing arm bushings with DC 111. Lubricate the mounting bolts with chassis grease before you reinstall them, then retorque them to 65 N-m (6.5 kg-m, 47 lb-ft).



Excess Glass Camber Ruins Regulator

If an '87-90 Legend Coupe comes in with a bad front door glass regulator, check the glass camber as described in S/B 88-023, "Wind Noise from the Door Glass." Too much negative camber (beyond the spec or even at the minus side of the spec) is hard on the regulator. And if you don't correct the glass adjustment now, the new regulator won't last either.



Legend Trunk Opener Won't Work

Here's a tip on inoperative '91 Legend remote trunk openers: Before you do any serious troubleshooting, cycle the trunk opener main switch (the one in the glove box) several times to "clean" the switch contacts. If this fails to get the opener working, then troubleshoot as necessary.

ACURA ServiceNews

©1991 American Honda Motor Co., Inc. - All Rights Reserved. Published by AHM Service Communications, 1919 Torrance Blvd., Torrance, CA 90501-2746. All suggestions become the property of American Honda Motor Co., Inc.; sending a suggestion gives Honda permission to publish it without further consideration.



WE SUPPORT
VOLUNTARY TECHNICIAN
CERTIFICATION THROUGH
National Institute for
AUTOMOTIVE
SERVICE
EXCELLENCE

BSN 14510 (9103)