

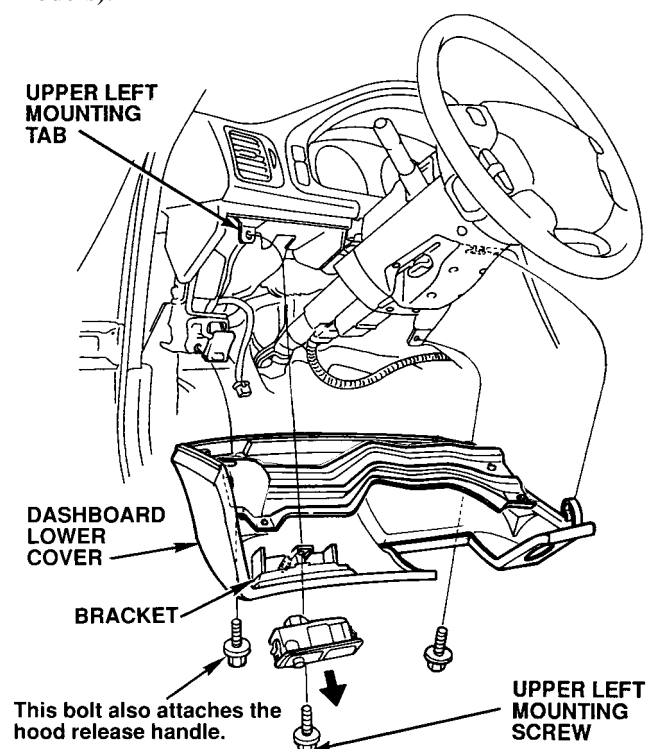

Legend Lower Dash Panel R & R

To avoid breaking the driver's-side lower dash panel bracket when removing said panel from a 1991 Legend, don't forget to remove the panel's upper left mounting screw. This screw often goes unnoticed because it's located behind the courtesy light controller (LS model) or the blank cover (Std. and L models).



The good news is: If the panel bracket is already broken, it can be ordered separately (P/N 77212-SP0-999, knee bolster bracket).

The bad news is: You may not be able to remove the courtesy light controller from an LS without damaging the controller or the lower dash panel. In this case, remove the two lower screws from the panel, then forcibly remove the panel by breaking the panel bracket. (The bracket is much cheaper than a new controller or lower dash panel.) Once the panel is off, you'll be able to remove the controller and replace the bracket for reassembly.

To reinstall the lower panel so that it fits tightly against the dash, tighten the upper left mounting screw first, while pushing the panel up and forward. If there's still a gap between the lower panel and the dash, bend the upper left mounting tab on the dash up and forward.



Climate Control Display Adjustment

The climate control temperature display reading on 1991 Legend LS models is adjustable. If the customer feels the display reads slightly higher or lower than the actual temperature inside the car, here's what you do:

Pull the temperature control knob off with your fingers. Above the knob shaft is a small three position slide switch. The factory sets the switch in the middle position. Sliding the switch to the right (+) side lowers the display reading by about 35; sliding the switch to the left (-) side raises the display reading by about 35.

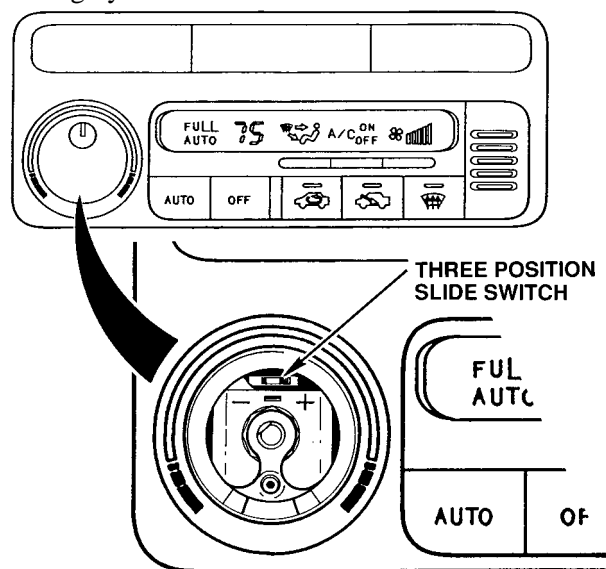

Tips from Tech Line

Passenger airbag alignment: If the airbag assembly doesn't quite fit flush with the dash, it can be adjusted. Remove the glove box, loosen the airbag bracket hardware, then move the brackets as needed.

Passive seat belt troubleshooting: Before calling Tech Line for troubleshooting assistance on a 1990-91 Integra passive seat belt system, perform the input tests in the S/M* and record the voltages. Without the voltages, there's nothing Tech Line can do. If you're looking for shortcuts, re-read the July 1990 issue of S/N.

* In case you missed it, there's one input test correction in the September 1990 issue of S/N.

Lost anti-theft codes: The phone number for lost anti-theft radio codes has been changed. The new number is 310-783-3240.

ACC Trailer Hitches and Wiring

Trailer hitch kits designed specifically for 1991 Legends and other Acura models are manufactured and distributed by:

Carroll Smith Consulting, Inc.
 1236 Via Landeta
 Palos Verdes Estates, CA 90274
 Phone: 310-375-7192 FAX: 310-373-7042

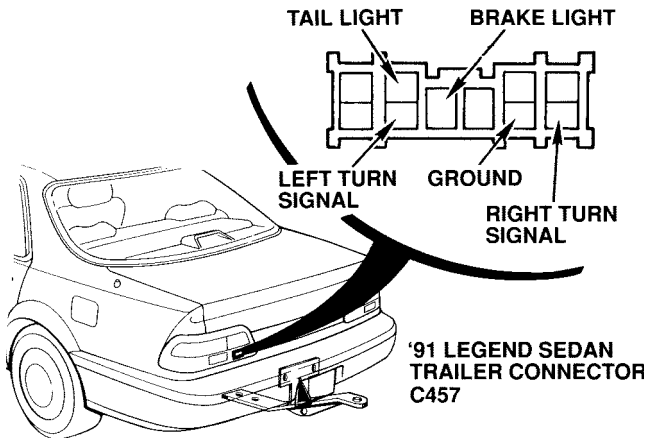

Included in each kit is the converter that makes the brake light and turn signal circuits on the car and trailer work in harmony. Most trailer lights use a dual filament bulb – one filament for the brake light and turn signal, and the other filament for the taillight. Acuras, on the other hand, use a dual filament bulb for the brake light and taillight, and a separate single filament bulb for the turn signal.

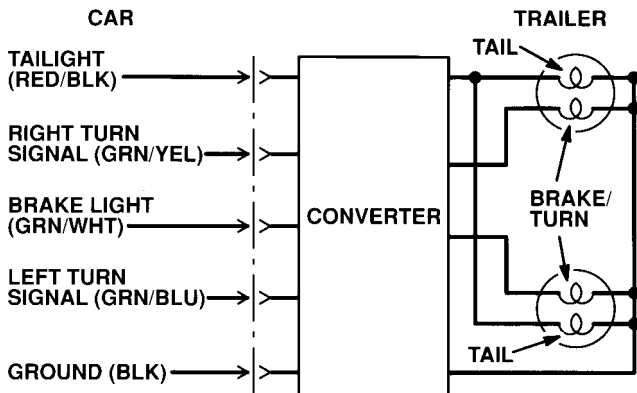

The converter uses diodes between the brake and turn inputs to route the signals to the appropriate outputs.

All Legends and 1990-91 Integras come pre-wired with a trailer connector that's taped to the rear wire harness behind the left taillight access door. Carroll Smith currently supplies matching connectors for only the 1986-90 Legends, but he's trying to get

connectors for the other models. If the connector is not supplied for the car you're wiring, we recommend you make soldered splices.

The trailer wiring color codes for all Acuras are as follows:

Taillights	RED/BLK
Brake lights	GRN/WHT
Right turn signal	GRN/YEL
Left turn signal	GRN/BLU
Ground	BLK
Accessory lights	WHT/BLU

ACC '91 Legend Accessory Tips

Spoiler kit trunk springs: If the heavy-duty trunk springs won't hold the trunk lid open after they've "broken-in," adjust them forward to the higher tension position.

Adjust the trunk springs forward with the release tool as shown.

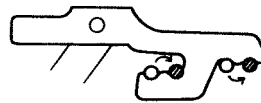

- = NORMAL POSITION
- = HIGHER TENSION

Fog light wiring: Looking for that 1-P connector with the BLU/RED wire that's supposed to be behind the driver's footrest? Actually, the fog light connector is taped to the harness behind the kick panel, in the corner where the floor meets the firewall. The 1-P connector that's under the footrest is for a trailer light indicator.

Cellular phone remote speaker: When you remove the glove box to install the phone speaker, mark the glove box light connector with a piece of tape. The glove box light and the speaker both use the same style/color connector, and if you mis-connect them, you'll ruin the speaker.

ACURA ServiceNews

©1991 American Honda Motor Co., Inc. - All Rights Reserved. Published by AHM Service Communications, 1919 Torrance Blvd., Torrance, CA 90501-2746. All suggestions become the property of American Honda Motor Co., Inc.; sending a suggestion gives Honda permission to publish it without further consideration.

