

YEAR  
1991-92

MODEL  
LEGEND  
4-DOOR

VIN APPLICATION  
See VEHICLES  
AFFECTED

BULLETIN NO.  
93-017



## Paint Peeling From Door Mirror

### PROBLEM

The paint is peeling off the door mirror housing.

### VEHICLES AFFECTED

All 1991-92 4-door Standard Legends with satin black door mirrors.

### CORRECTIVE ACTION

Replace the door mirror housing with the parts listed under PARTS INFORMATION.

1. Open the window of the front door.
2. Insert a #2 Phillips screwdriver through the service hole in the bottom of the mirror housing. Loosen the actuator retaining screw, but do not remove it.

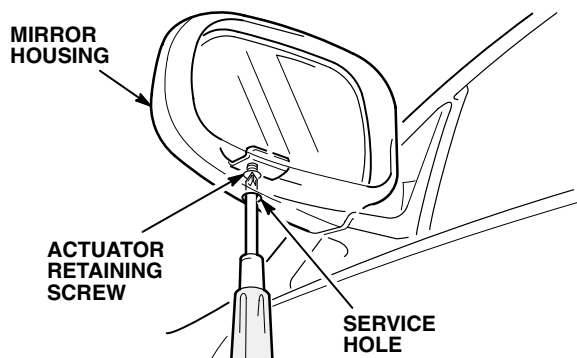

3. Remove the actuator and the mirror holder assembly from the mirror housing; then, disconnect the connector.

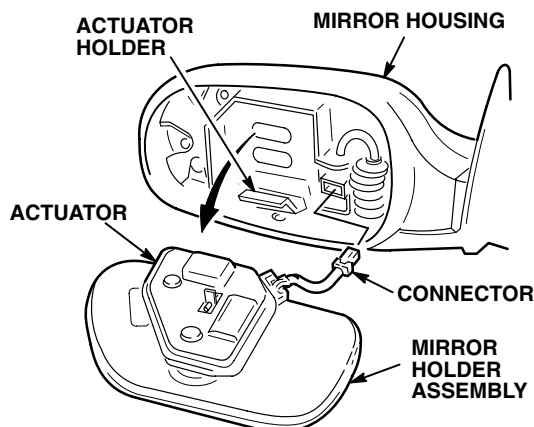

4. Pivot the mirror housing towards the front of the car until it locks in place.

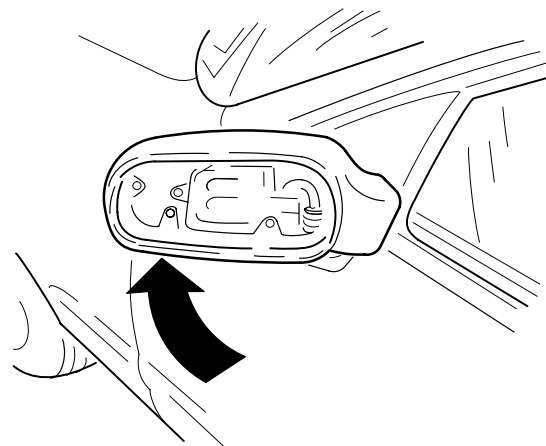

5. Remove the five screws that attach the bezel to the mirror housing. Pry the outer edge of the bezel away from the housing to release the clips on the pivot end.

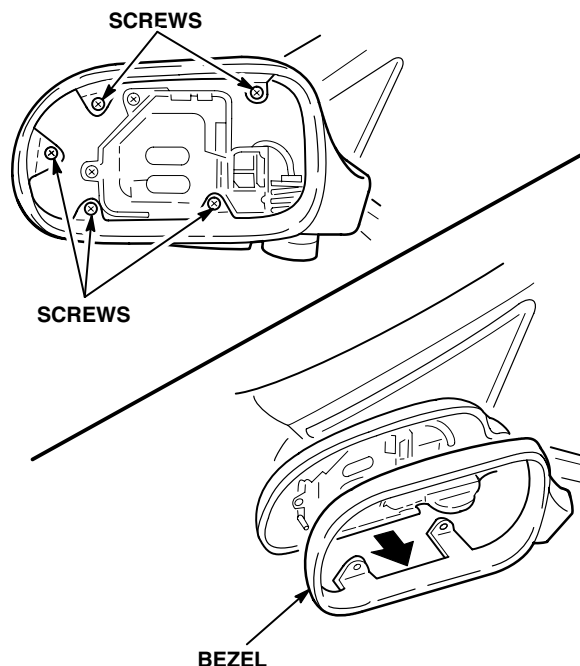

- Remove the screw at the pivot attaching the mirror housing to the frame. Pivot the housing all the way towards the side window until it locks in place.

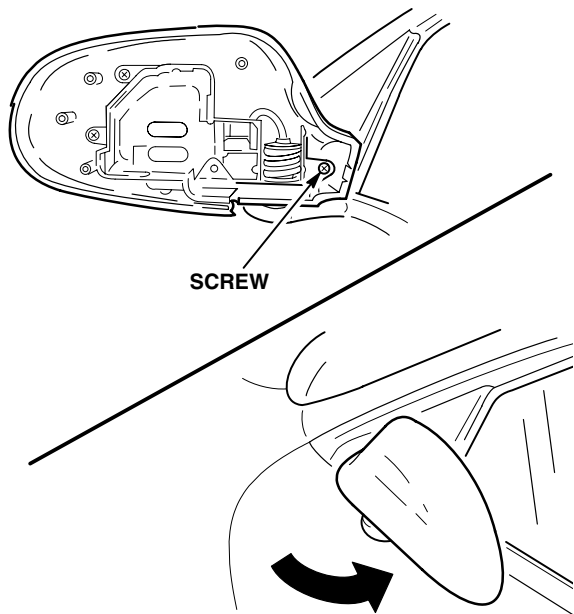

- Remove the last two screws attaching the mirror housing to the frame; then, remove the housing.

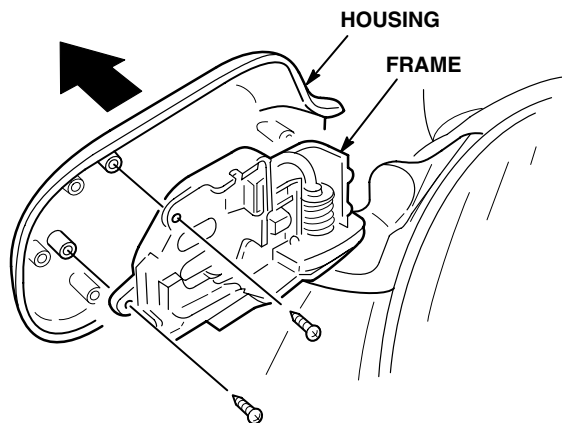

- Install the new mirror housing and bezel in reverse order of removal.

## PARTS INFORMATION

Left Mirror Housing: P/N 76251-SP0-A01ZJ  
(Satin Black)

Right Mirror Housing: P/N 76201-SP0-A01ZN  
(Satin Black)

## WARRANTY CLAIM INFORMATION

**In warranty:** The normal warranty applies.

**Out of warranty:** Any repair performed after warranty expiration may be eligible for goodwill consideration by the District Service Manager or your Zone Office. You must request consideration, and get a decision, before starting work.

Operation number: 820105 – Left

821105 – Right

Flat rate time: 0.2 hour per side

Failed P/N: 76251-SP0-A01ZJ

Defect code: Z86

Contention code: A01