

YEAR
1991 - 93

MODEL
LEGEND

VIN APPLICATION
See VEHICLES
AFFECTED

BULLETIN NO.
95-020



A/C Blows Warm Air Intermittently

SYMPTOM

The air conditioner system intermittently blows warm air. This condition may be difficult to duplicate.

PROBABLE CAUSE

A cracked solder joint on the fan control unit's printed circuit board causes the air conditioner compressor and fans to intermittently turn off.

VEHICLES AFFECTED

4-Door

1991-92: All

1993: Thru VIN JH4KA7...PC016233

2-Door

1991-92: All

1993: Thru VIN JH4KA8...PC001822

CORRECTIVE ACTION

Inspect the fan control unit's printed circuit board. If necessary, replace the fan control unit with the new unit listed under PARTS INFORMATION.

1. Remove the passenger's side door sill molding and kick panel.
2. Pull back the carpeting to expose the ECM bracket, then remove the ECM bracket mounting nuts.

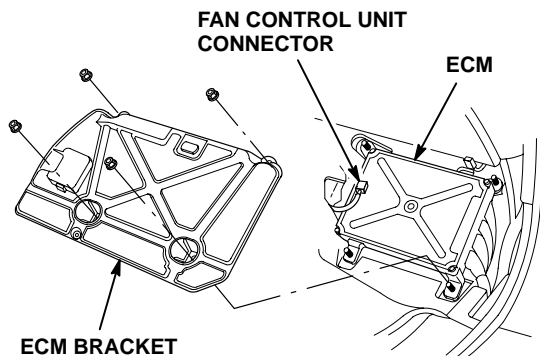

3. Disconnect the fan control unit connector, and remove the fan control unit from the ECM bracket.

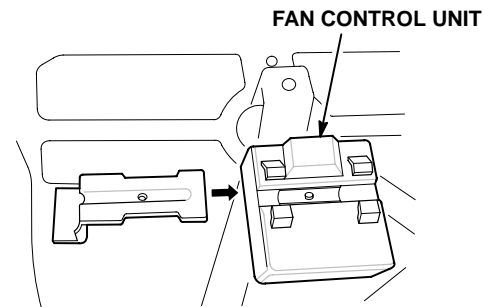

4. Release the four tabs on the fan control unit housing with a small screwdriver, then remove the printed circuit board.
5. Inspect the two solder joints indicated with a magnifying glass to see if they are cracked.

PRINTED CIRCUIT BOARD

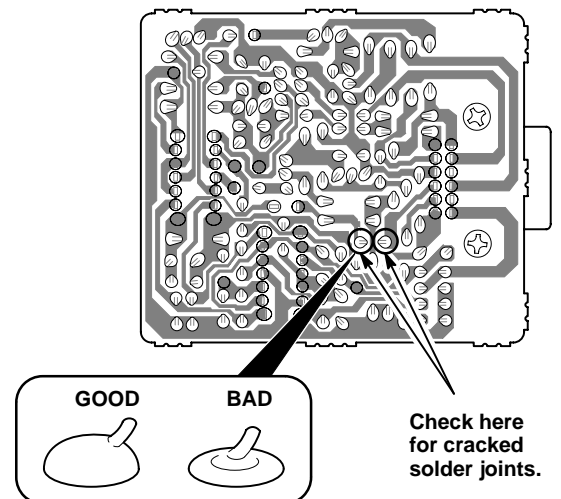

- If either of the solder joints are cracked, replace the fan control unit (see PARTS INFORMATION).
- If the solder joints are not cracked, continue troubleshooting the air conditioner system to locate the cause of the problem.

PARTS INFORMATION

Fan control unit: P/N 37735-PY3-901

WARRANTY CLAIM INFORMATION

In warranty: The normal warranty applies.

Out of warranty: Any repair performed after warranty expiration may be eligible for goodwill consideration by the District Technical Manager or your Zone Office. You must request consideration, and get a decision, before starting work.

Operation number: 615102

Flat rate time: 0.6 hour

Failed P/N: 37735-PY3-901

Defect code: 068

Contention code: B01